

- Notes.
Notas.
1. All Concrete to be 35 Mpa. @ 21 Days
 2. All reinforcing to be 75mm off bottom of foundations.
 3. All reinforcing to have a min. of 25mm cover at all times.
 4. All Bricks to be of structural quality as per S.A.B.S. 0400-1990
 5. All Mortar to be Class II as per S.A.B.S. 0400-1990
 6. All dimensions must be checked with Architect drawings.
 7. All steel must be checked by Engineer before concrete is poured
 8. Position and detail of all sleeving to be in accordance with TELKOM specifications.

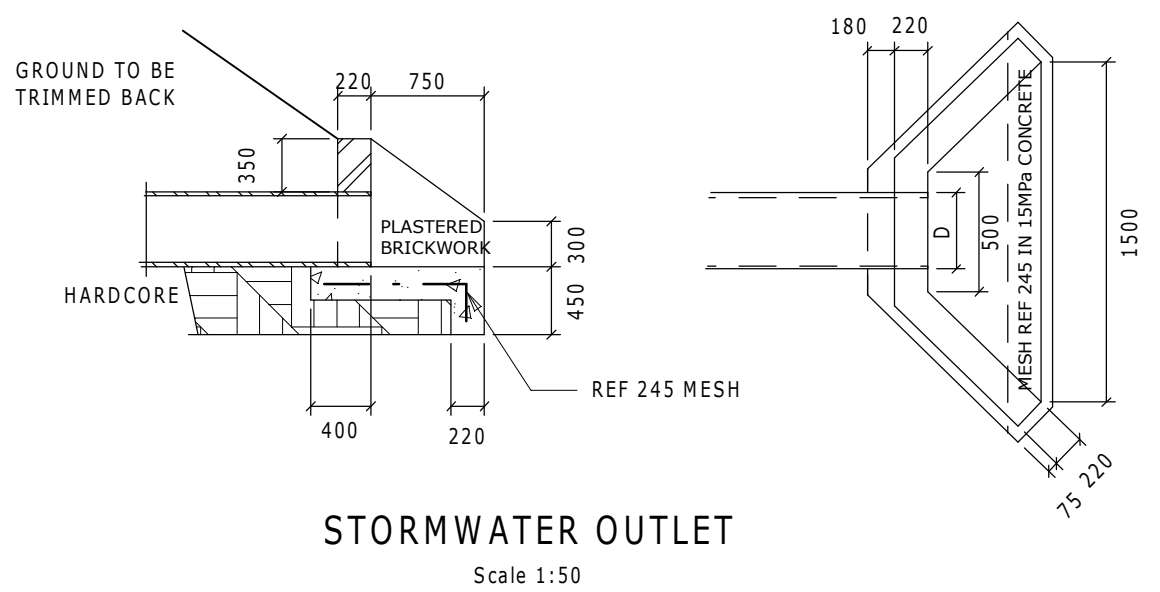
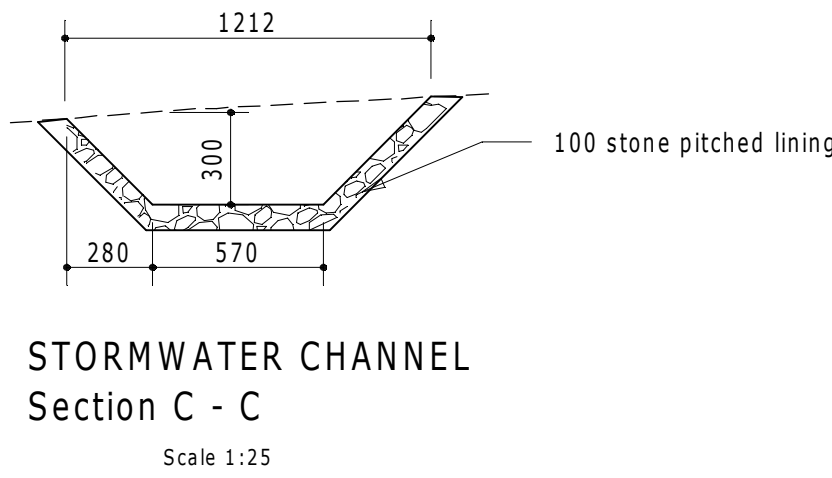
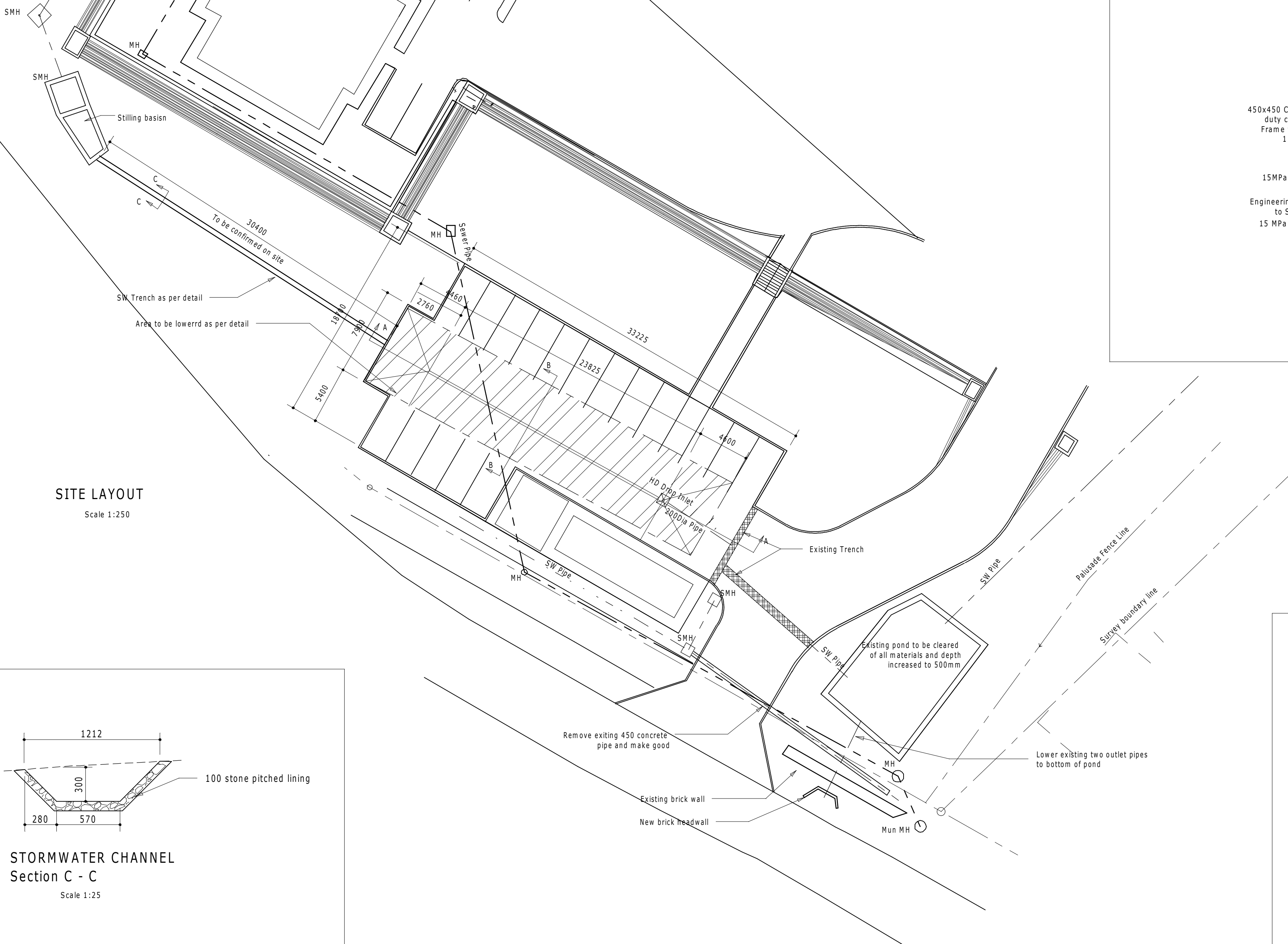
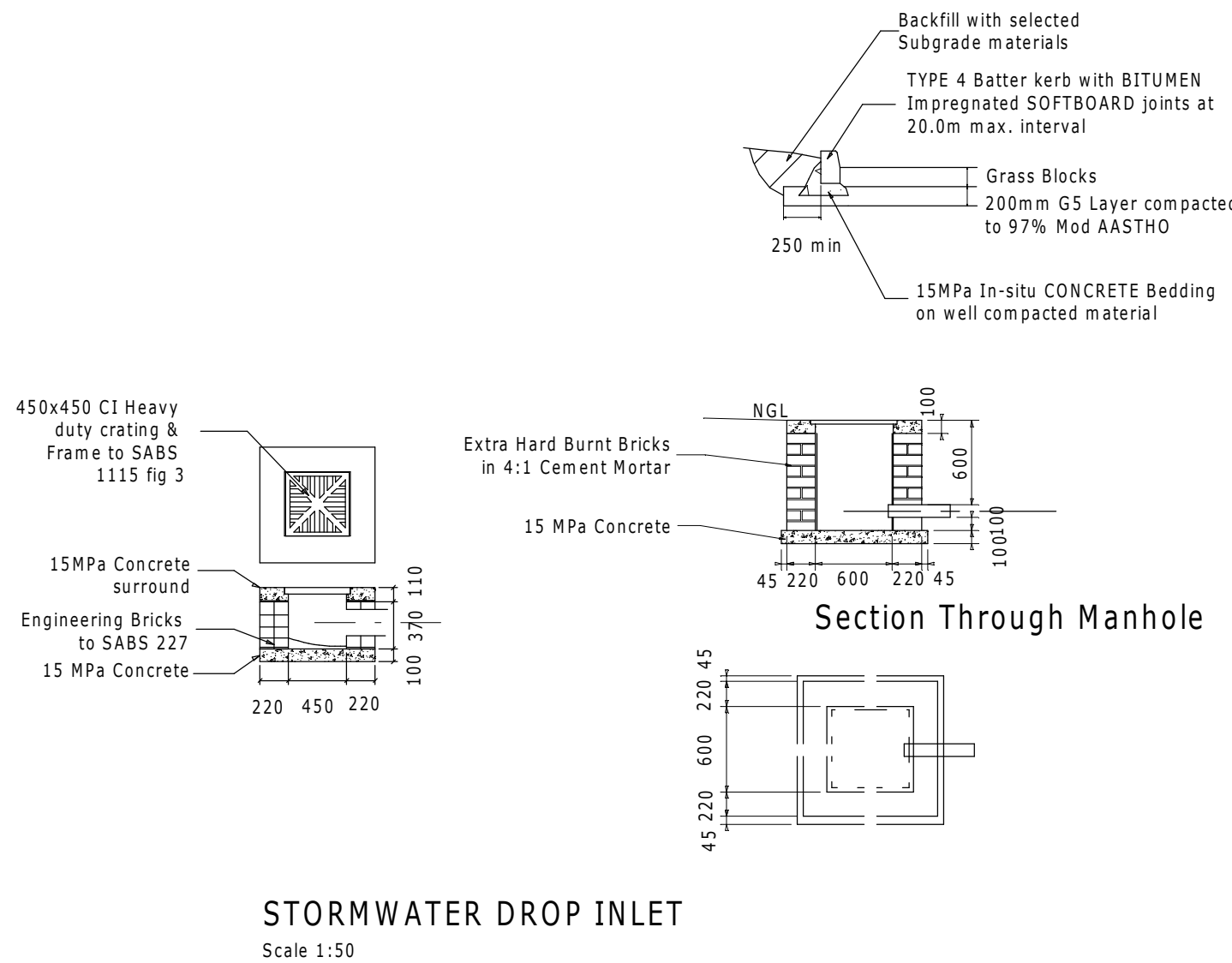
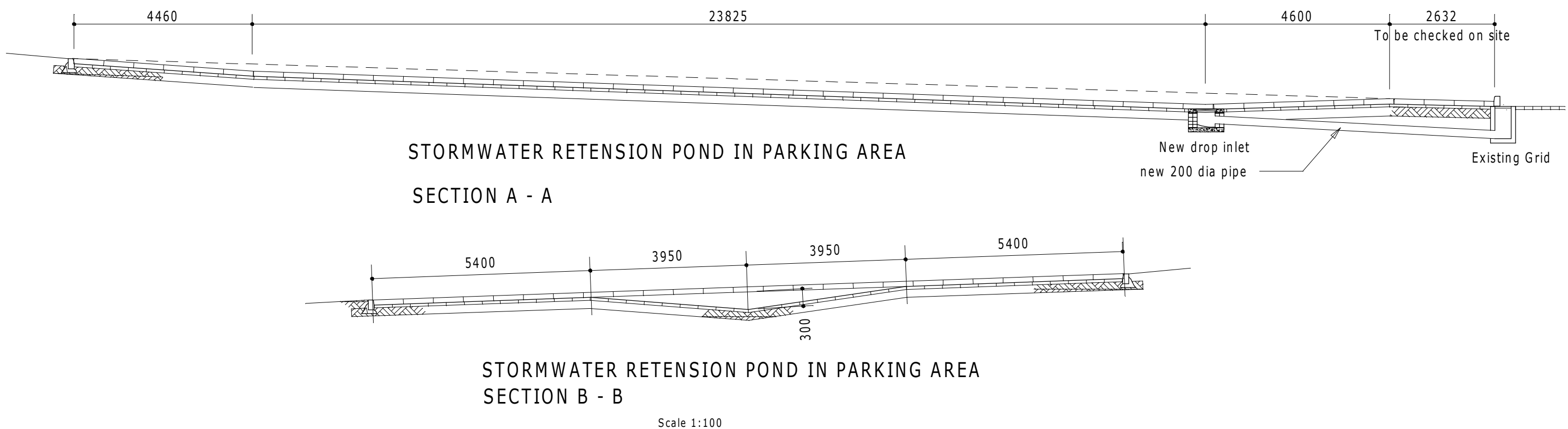

Date	By	No	Description
------	----	----	-------------

Revisions

Fj Consulting Engineers cc
Civil Struct Eng & Proj Man
Tel: 043 726 6256
East London

Client:
Klient:
NATIONAL DEPARTMENT of HEALTH

Project:
Projek:
ETHANDAKHUKANYE CLINIC

Drawing:
Tekening:
STORM WATER POND

Drawing No: Tekening No:	25-001-002	REV. No: 0
Scale Skaal	Designed Ontwerp H P Jooste 830362	Drawn Geteken HPJ 08-10-25